

# Drawer Inner Assembly

DIA - 1.0

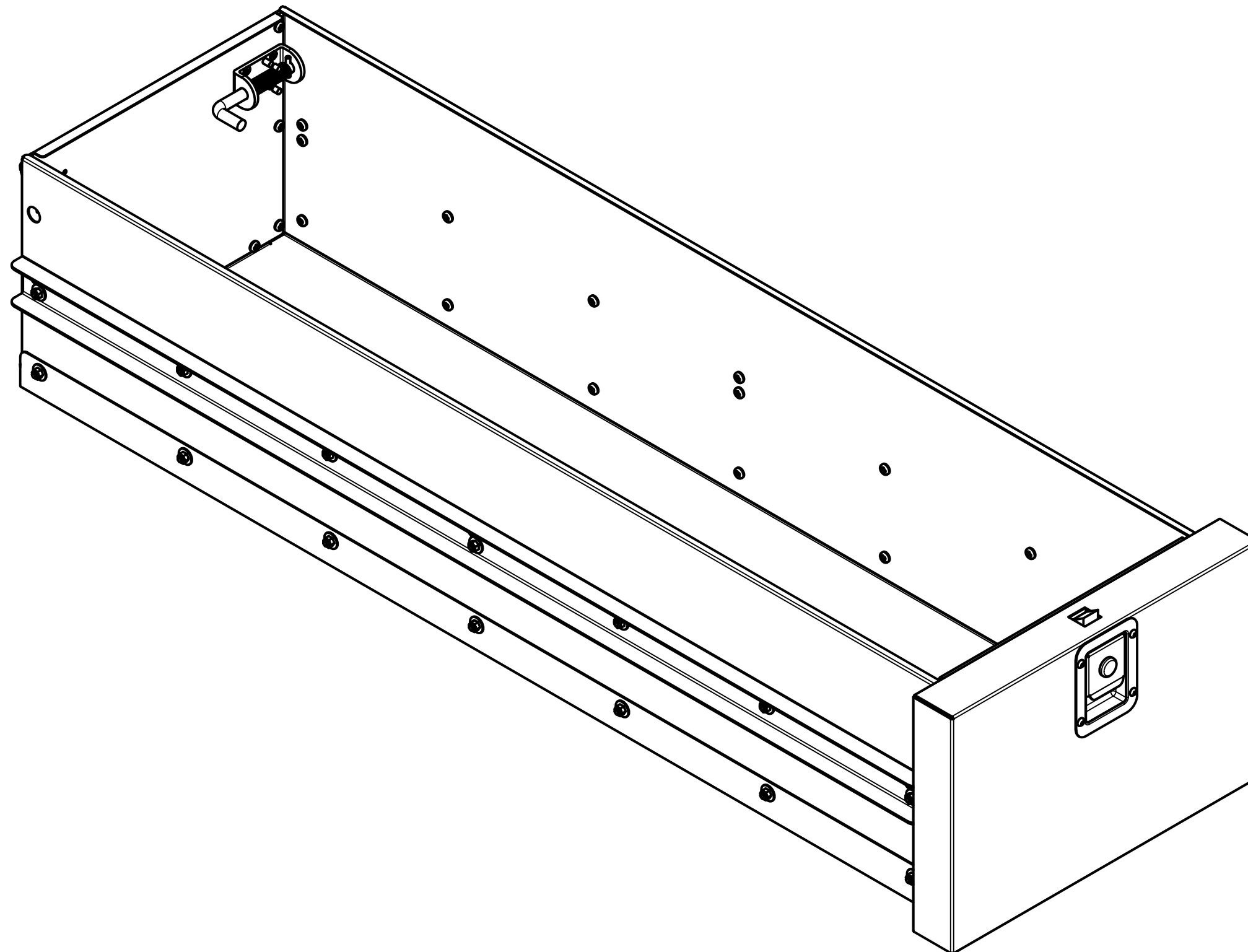

**MAS**  
**SYSTEMS**

massystems.com.au  
enquiries@massystems.com.au

# ISO Views

DIA - 1.1

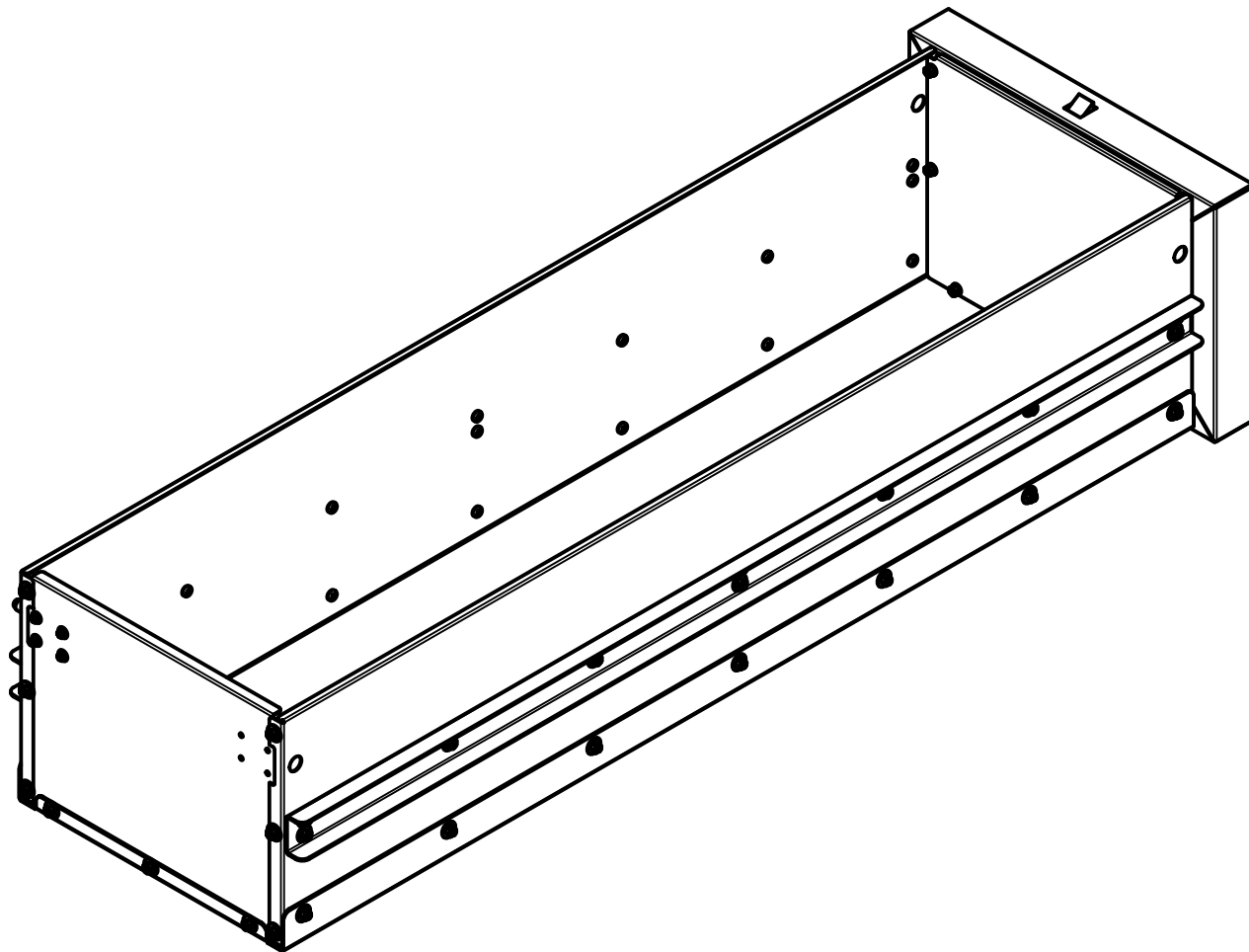

ISO Rear

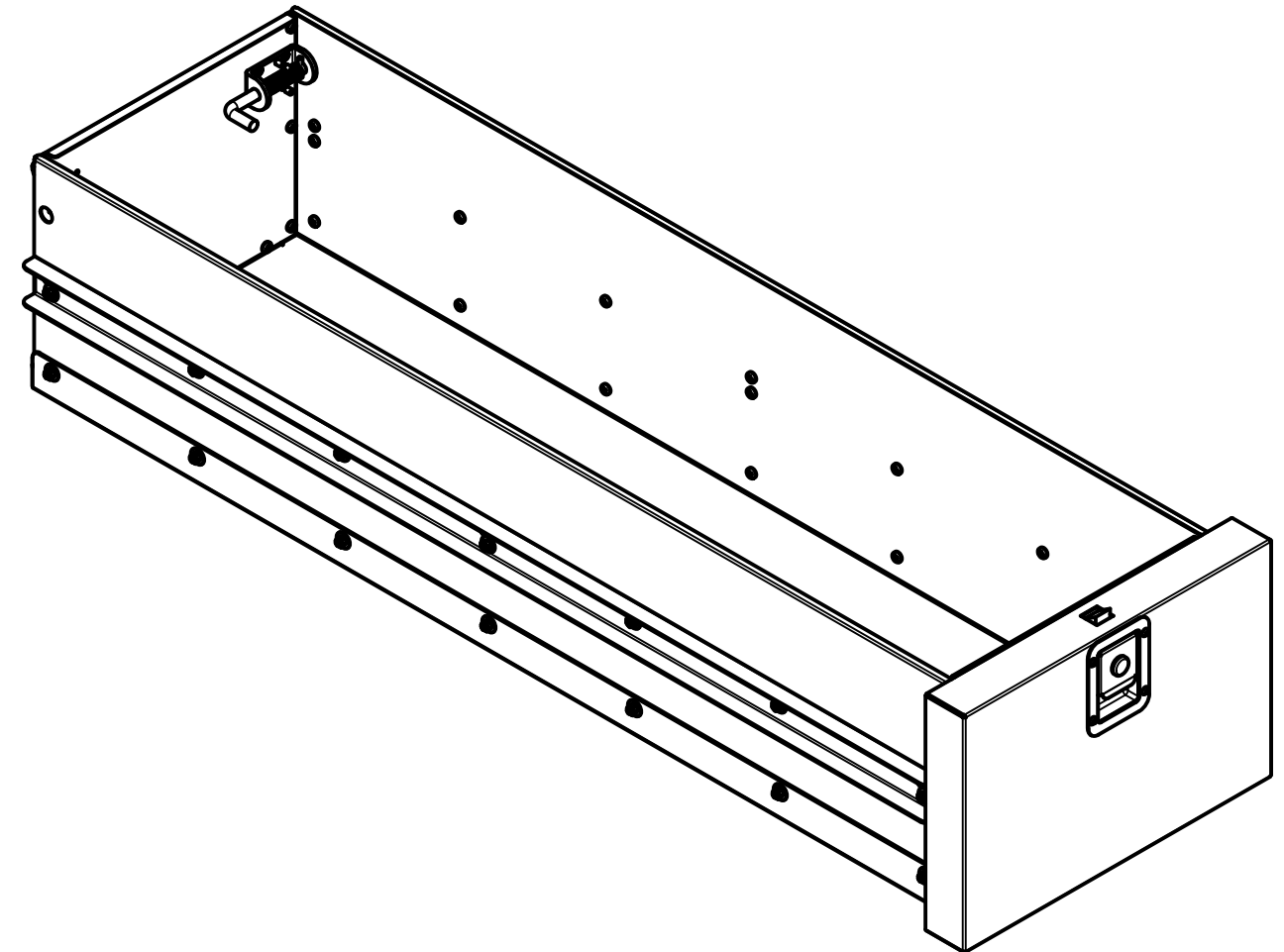

ISO Front

# Plan Views

DIA - 1.2

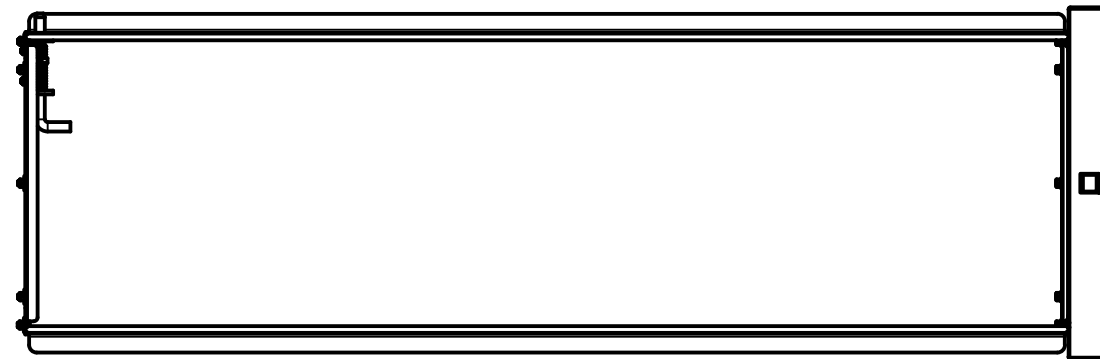

Top view

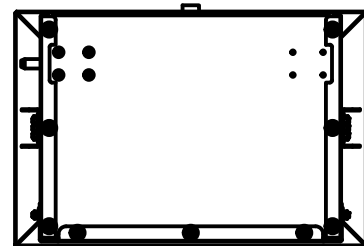

Rear View

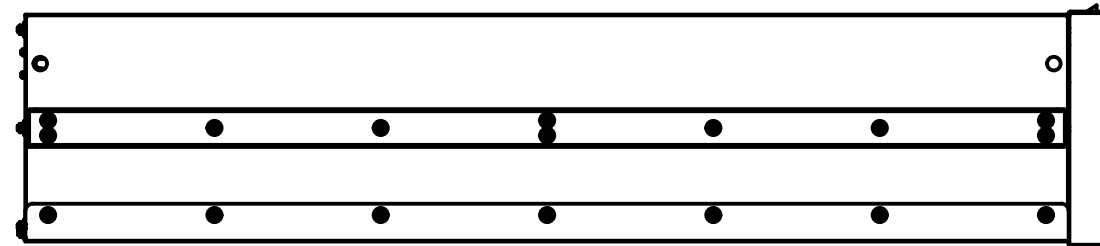

Side View

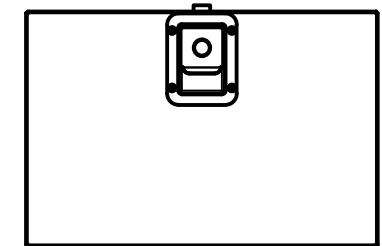

Front View

# Sectional Views

DIA - 1.3

RR Sect

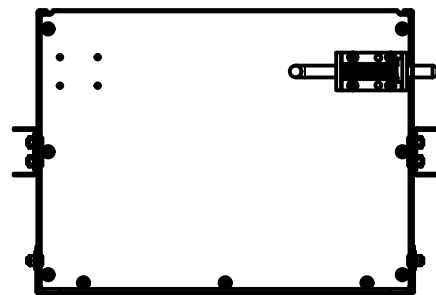

RR



FRT



RR



FRT



FRT Sect

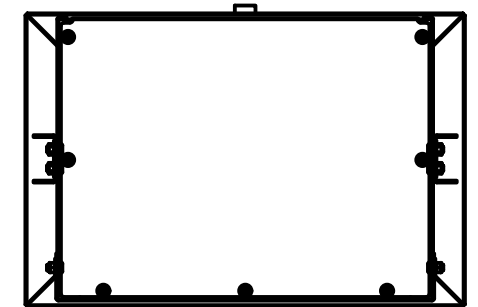

# Sheet Metal Components Exploded

DIA - 1.4

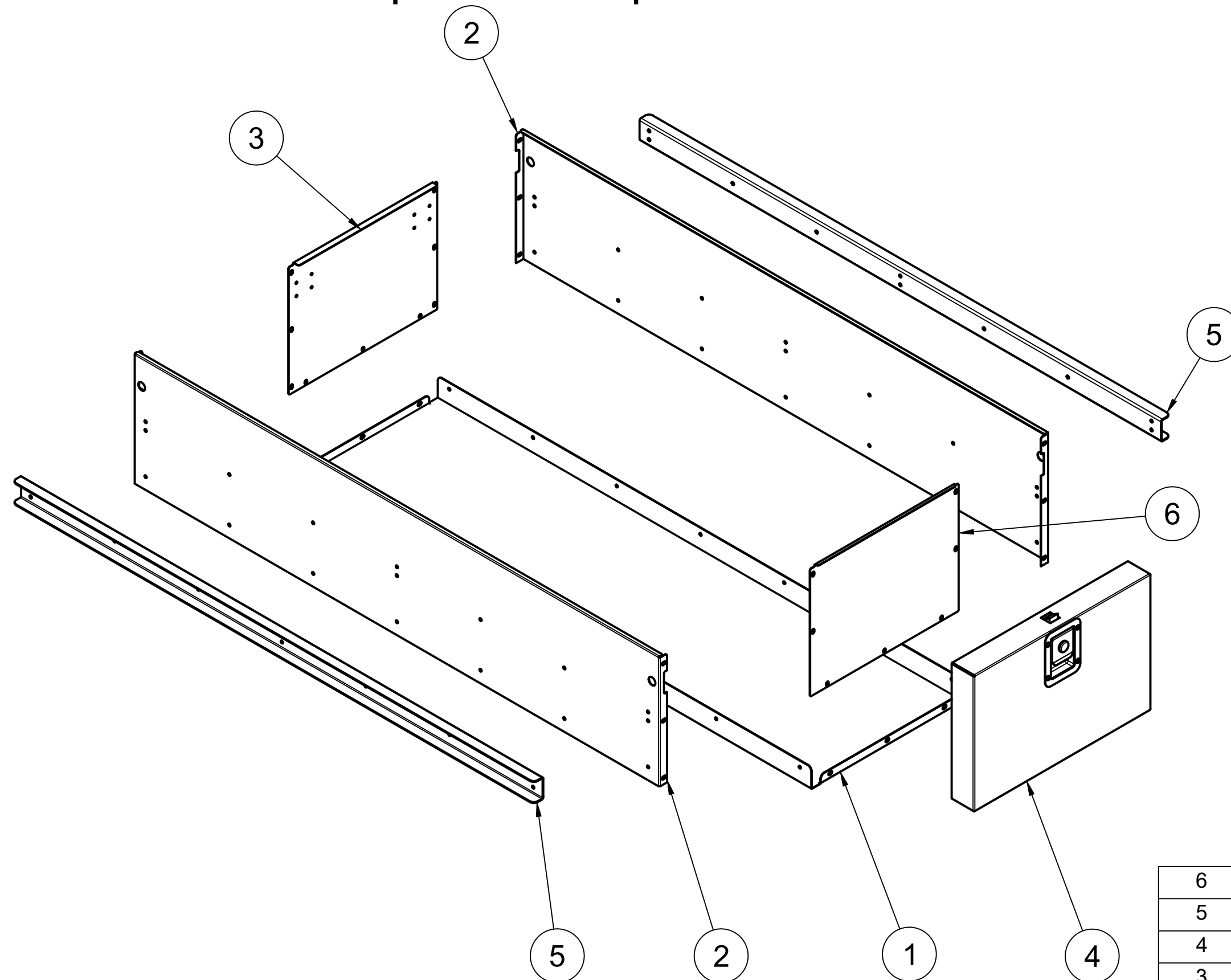

6	1	Drawer Front Reveal Panel
5	2	Drawer Rail
4	1	Drawer Front
3	1	Drawer Back
2	2	Drawer Side
1	1	Drawer Base
Item	Qty	Description
Parts List		

**MAS**  
**SYSTEMS**

massystems.com.au  
enquiries@massystems.com.au

# Step 1: Drawer Base to Side Assy (RH)

DIA - 2.0

- Bolt assembly installation order is not critical.
- Initially install all bolt assemblies hand tight.
- Once all bolt assemblies are in place, fully tighten.
- Recommended Assembly Torque for M6 Bolts = 3.5 Nm.

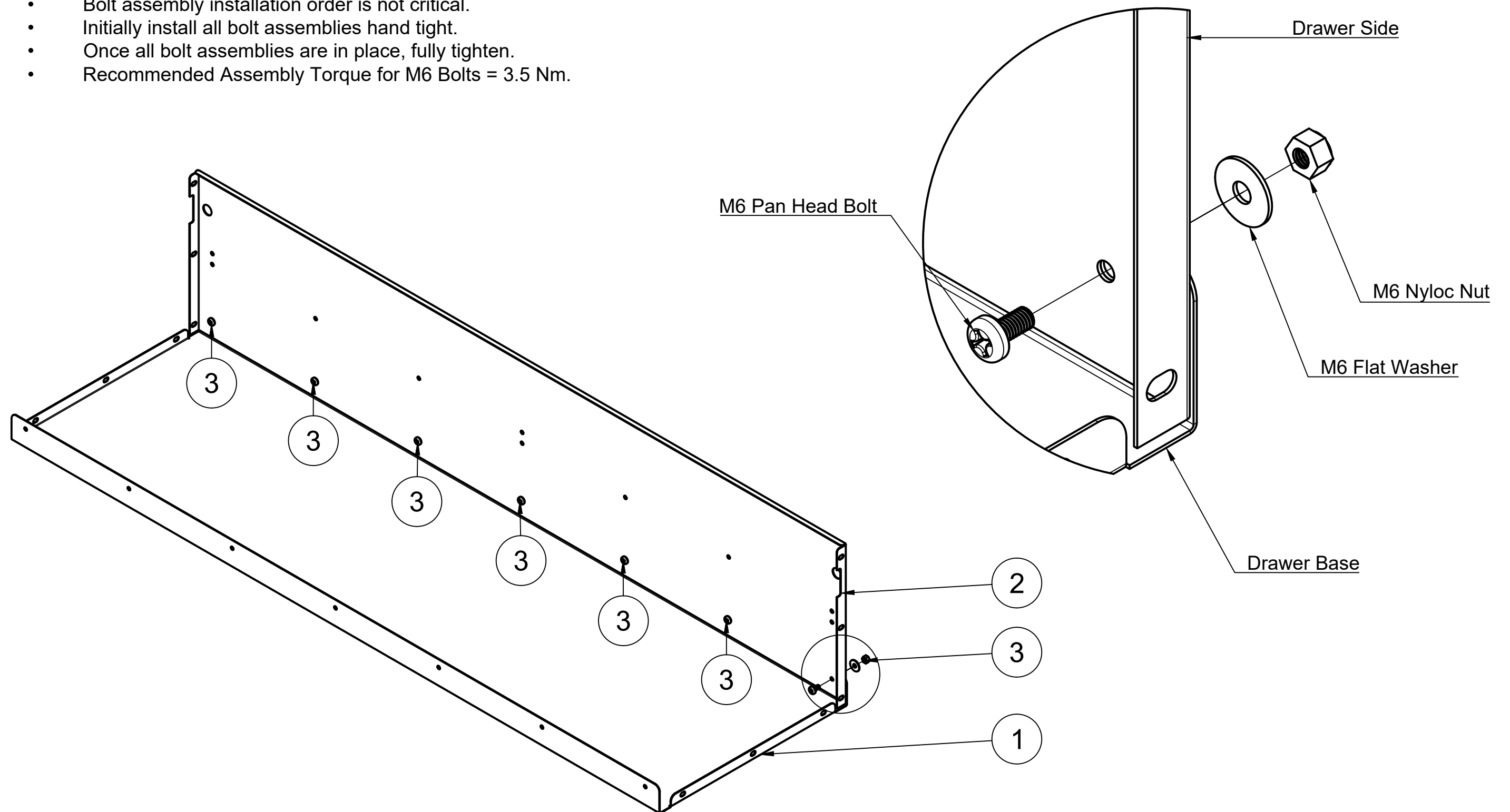

**MAS**  
**SYSTEMS**

masssystems.com.au  
enquiries@masssystems.com.au

3	7	M6 Pan Head Bolt Assy
2	1	Drawer Side
1	1	Drawer Base
Item	Qty	Description
Parts List		

# Step 2: Drawer Base to Side Assy (LH)

DIA - 3.0

- Bolt assembly installation order is not critical.
- Initially install all bolt assemblies hand tight.
- Once all bolt assemblies are in place, fully tighten.
- Recommended Assembly Torque for M6 Bolts = 3.5 Nm.

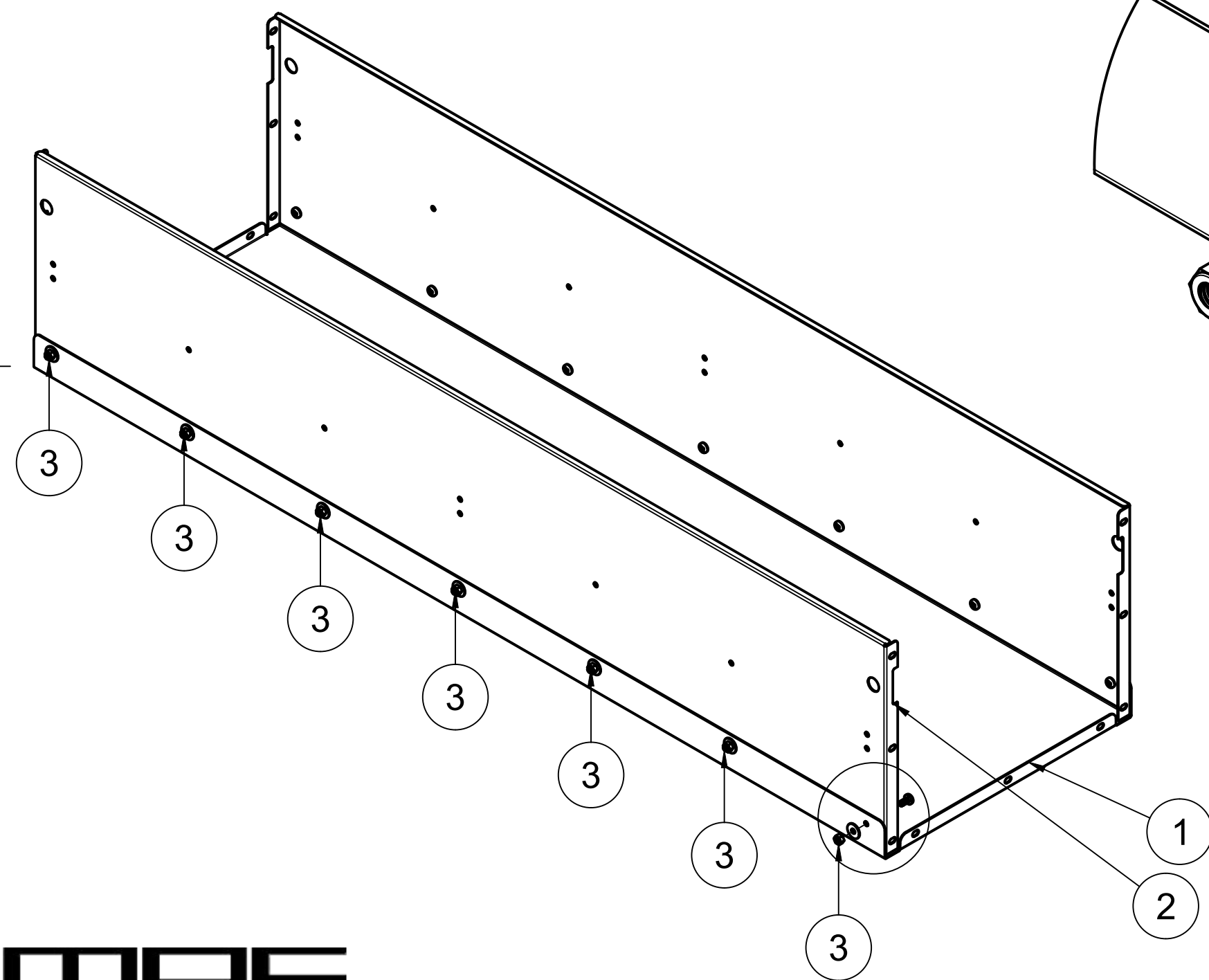
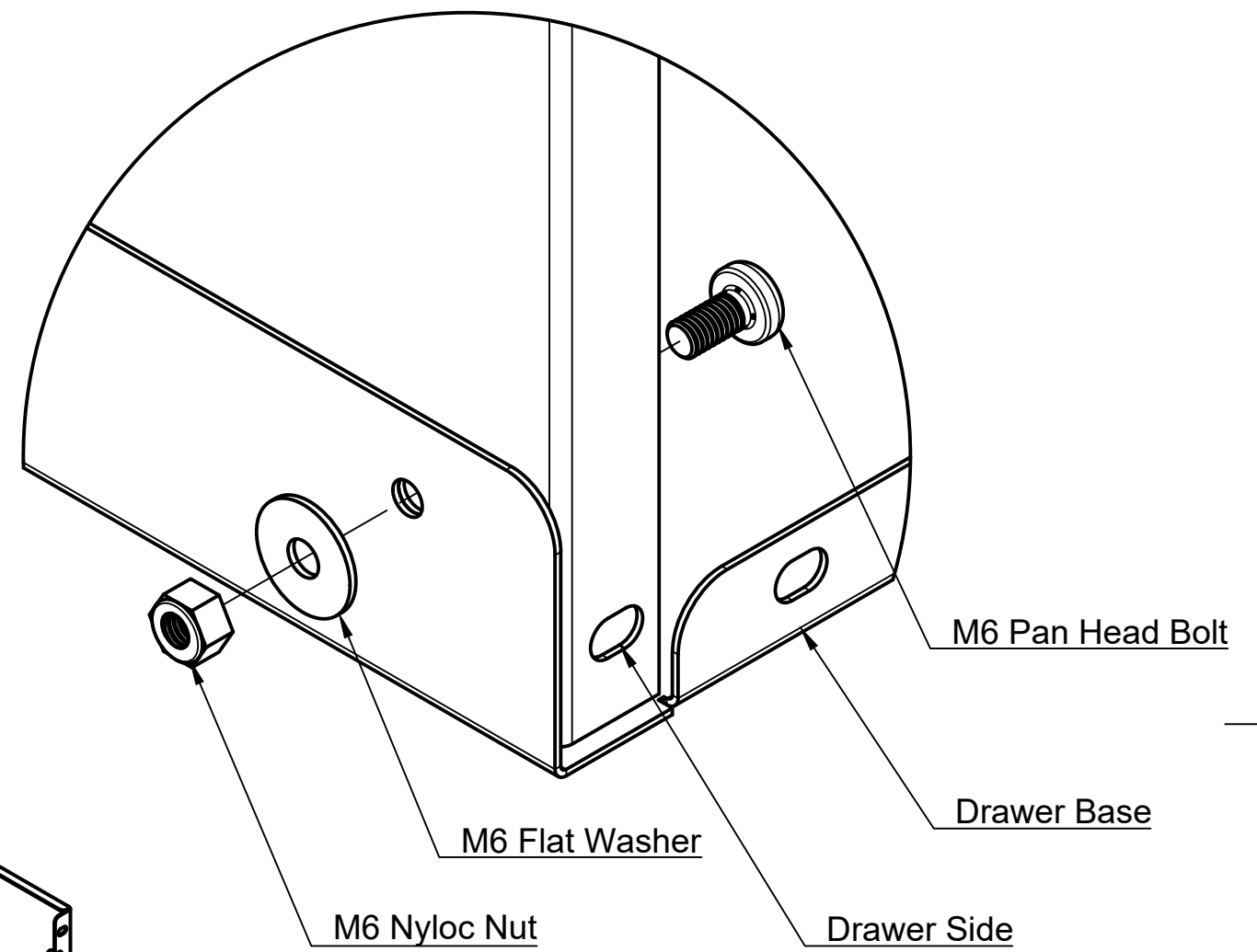

masssystems.com.au  
enquiries@masssystems.com.au

3	7	M6 Pan Head Bolt Assy
2	1	Drawer Side
1	1	Drawer Base
Item	Qty	Description
Parts List		

# Step 3: Drawer Back Installion

DIA - 4.0

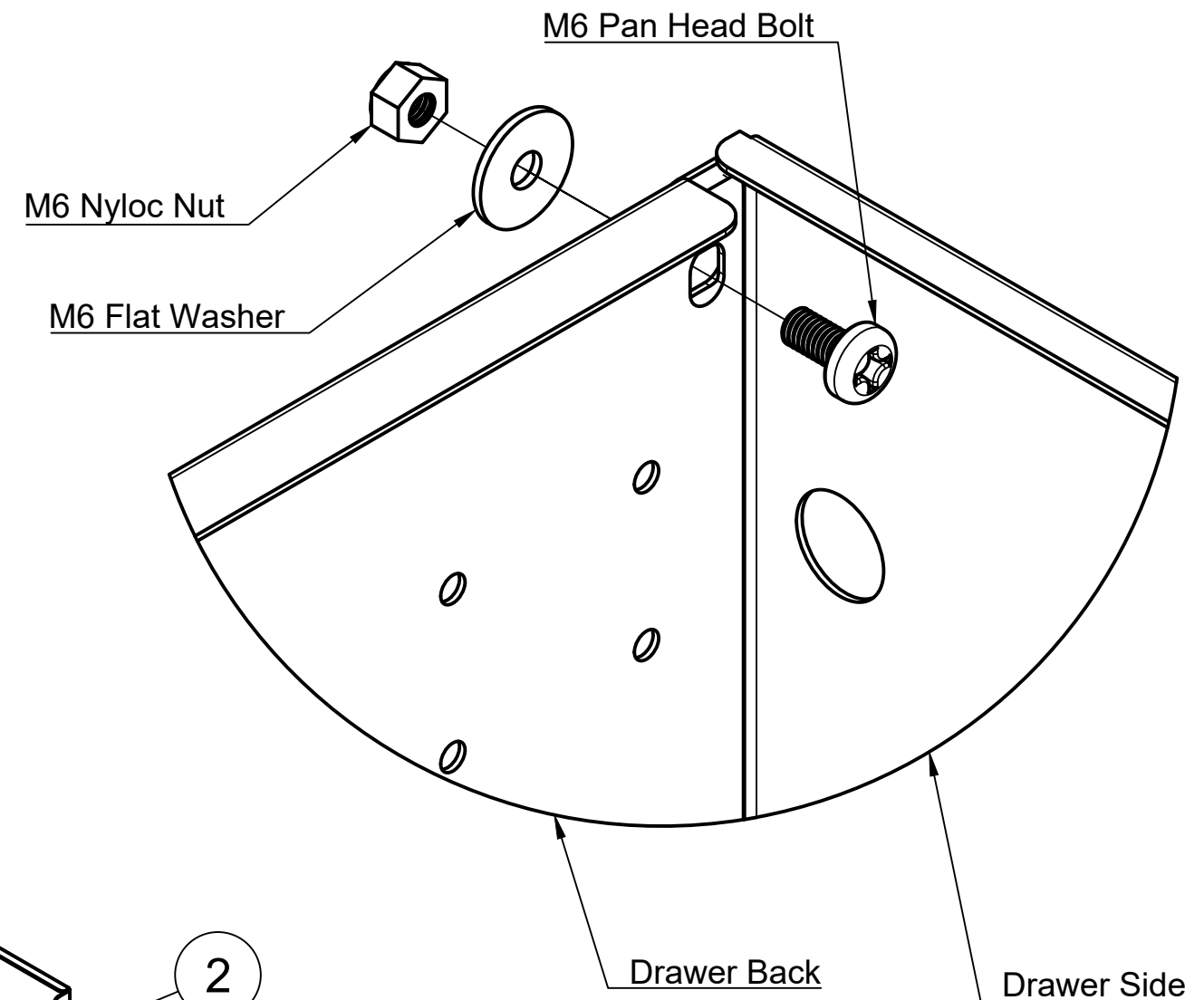
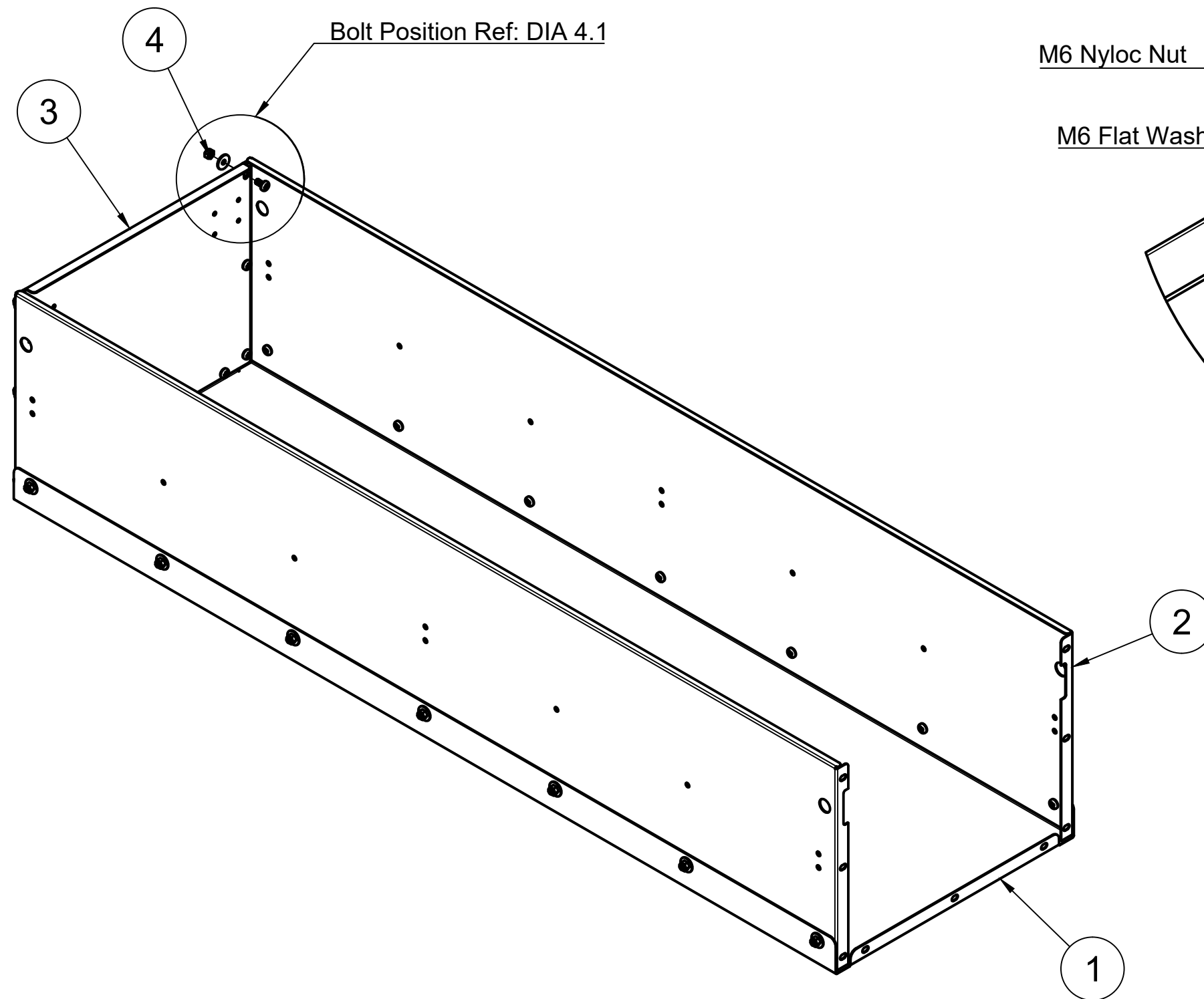

- Bolt assembly installation order is not critical.
- Initially install all bolt assemblies hand tight.
- Once all bolt assemblies are in place, fully tighten.
- Recommended Assembly Torque for M6 Bolts = 3.5 Nm.

**MAS**  
**SYSTEMS**

masssystems.com.au  
enquiries@masssystems.com.au

4	9	M6 Pan Head Bolt Assy
3	1	Drawer Back
2	1	Drawer Side
1	1	Drawer Base
Item	Qty	Description
Parts List		



# Step 3.1: Drawer Back Bolt Positions

DIA - 4.1

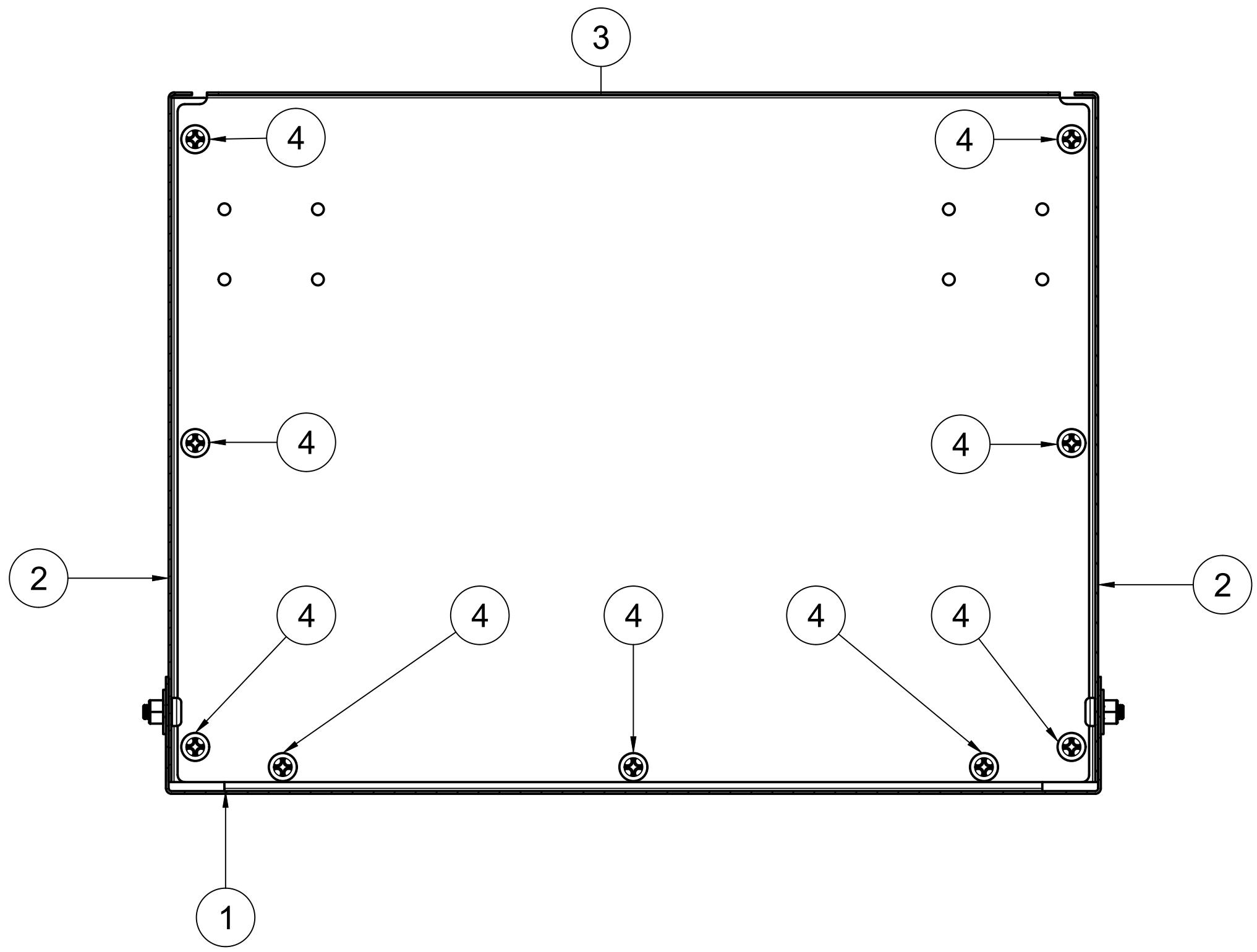

4	9	M6 Pan Head Bolt Assy
3	1	Drawer Back
2	1	Drawer Side
1	1	Drawer Base
Item	Qty	Description
Parts List		

# Step 4: Drawer Front Installation

DIA - 5.0

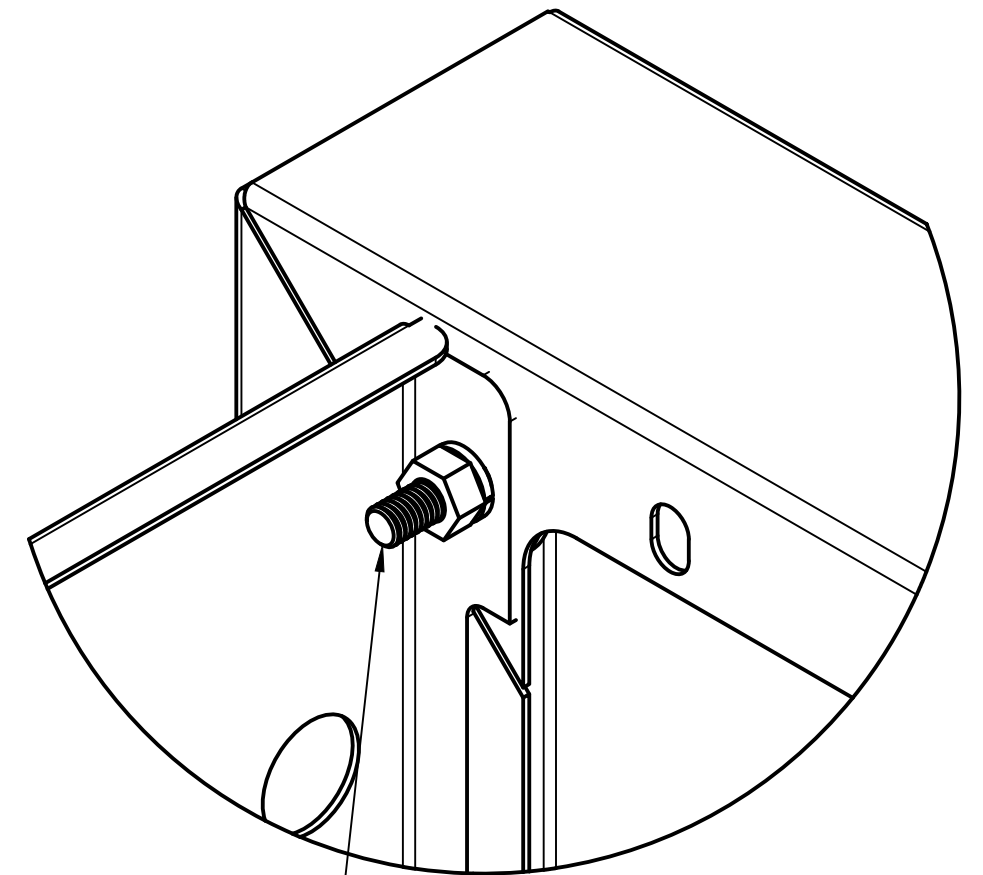
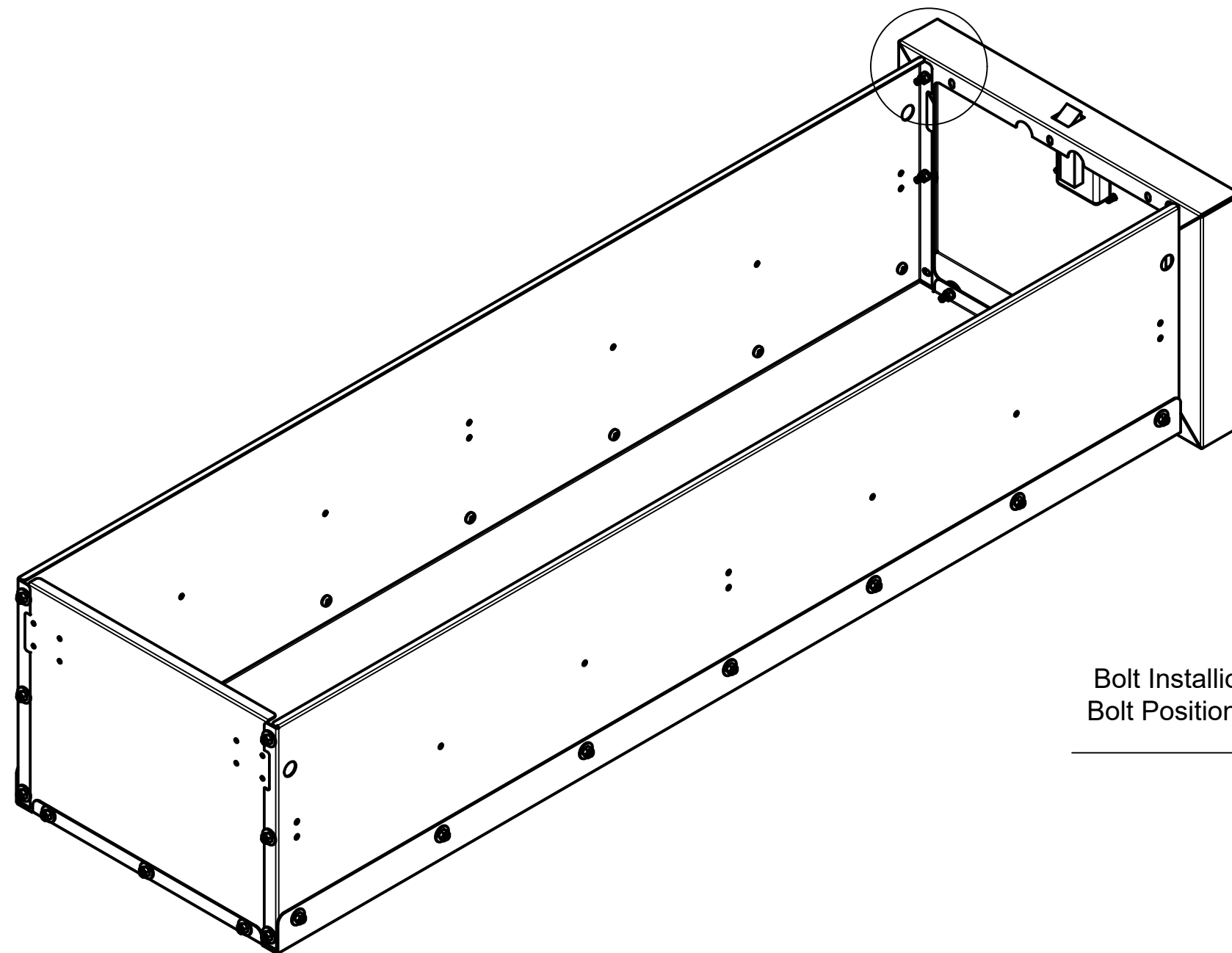

Bolt Installion Ref DIA 5.1  
Bolt Positions Ref DIA 5.2

# Step 4.1: Drawer Front Bolt Stack Installation

DIA - 5.1

- Bolt assembly installation order is not critical
- Initially install all bolt assemblies hand tight
- Once all bolt assemblies are in place, **nip tighten.**
- During installation / adjustment these bolt assemblies will be fully tighten

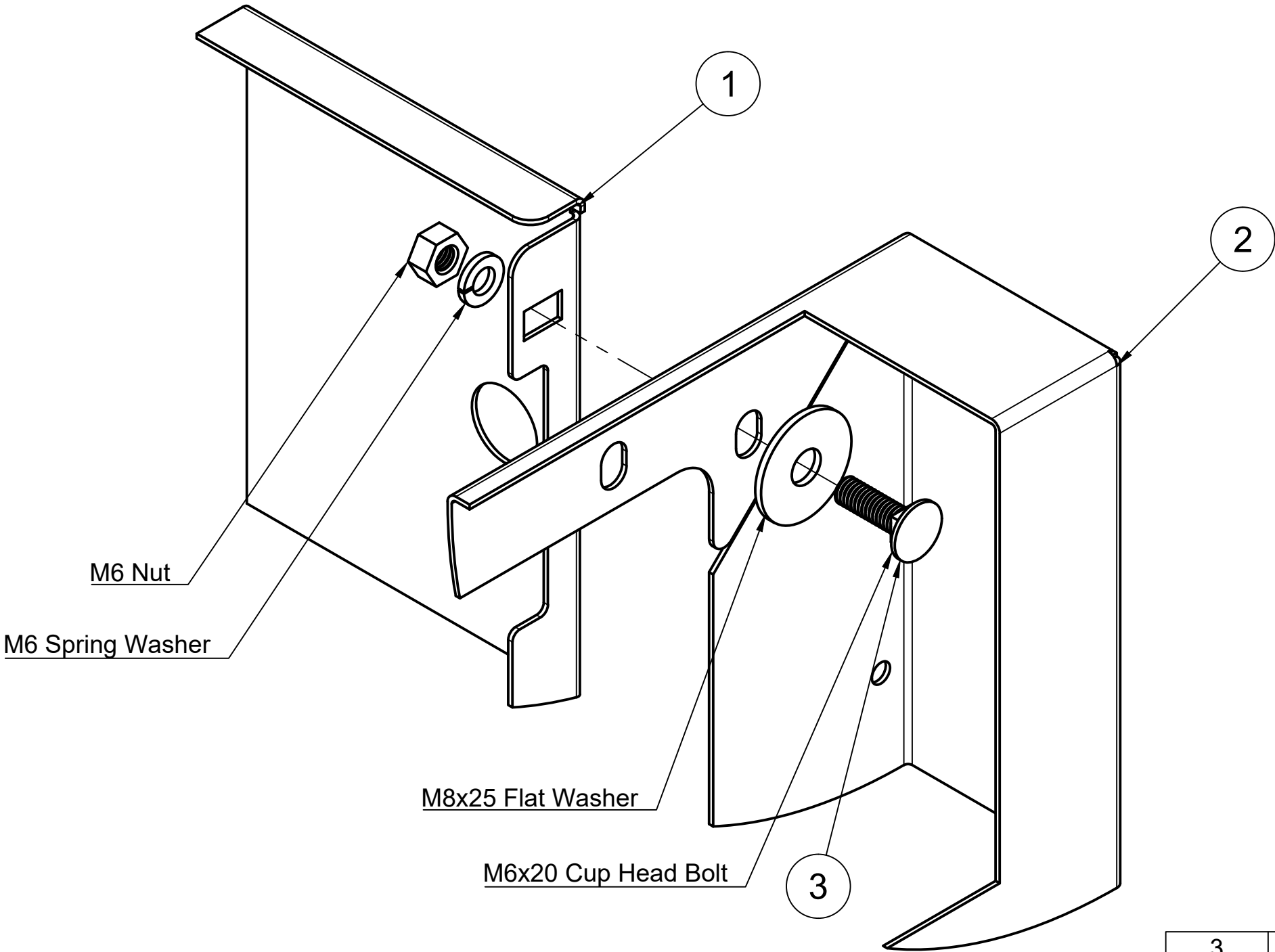

3	7	M6x20 Cup Head Bolt Assy
2	1	Drawer Front
1	1	Drawer Side
Item	Qty	Description
Parts List		

# Step 4.2: Drawer Front Bolt Positions

DIA - 5.2

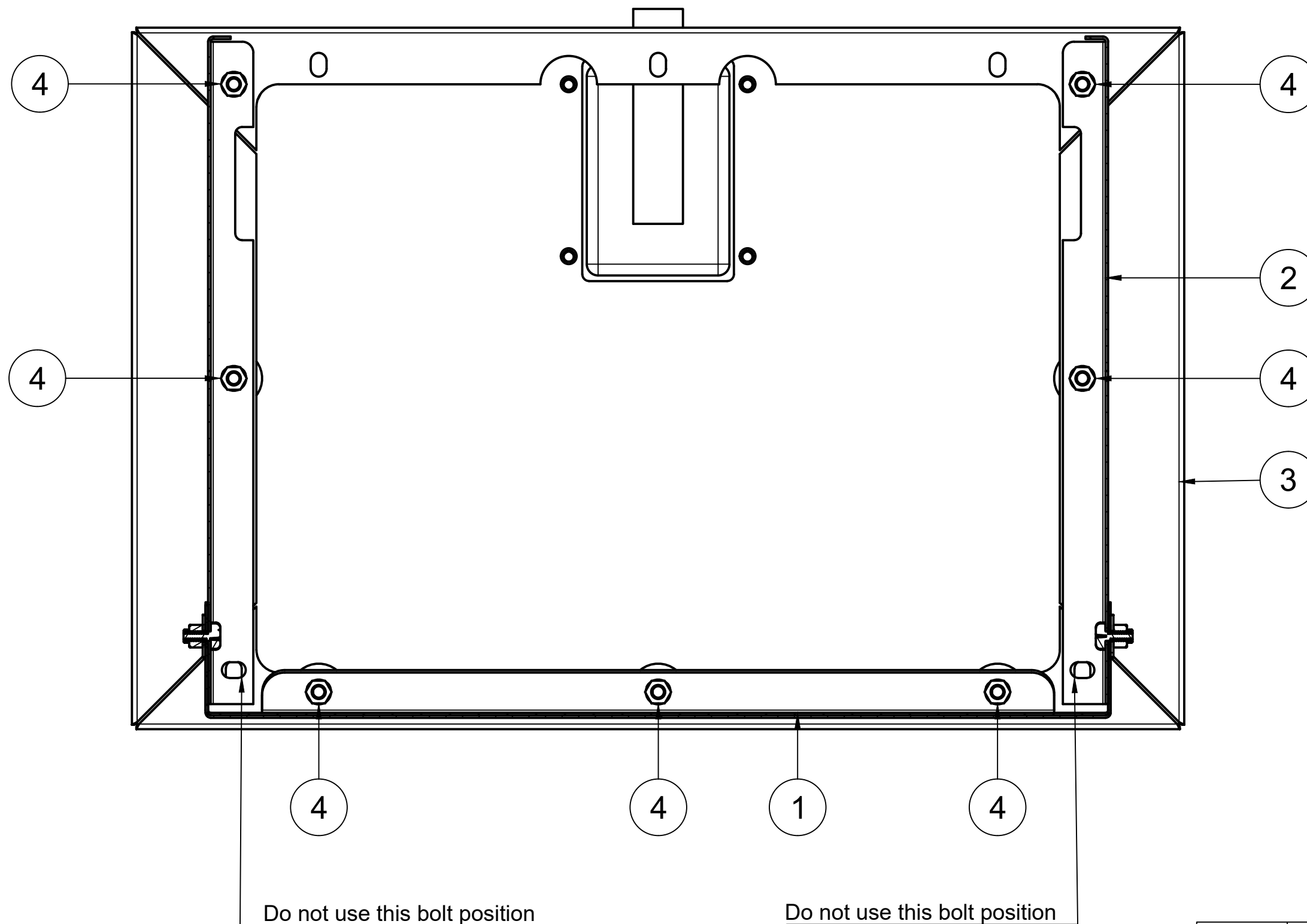

4	7	M6 Pan Head Bolt Assy
3	1	Drawer Front
2	1	Drawer Side
1	1	Drawer Base
Item	Qty	Description
Parts List		

# Step 5.1: Drawer Rail Installation (RH)

DIA - 6.0

- Bolt assembly installation order is not critical.
- Initially install all bolt assemblies hand tight.
- Once all bolt assemblies are in place, fully tighten.
- Recommended Assembly Torque for M6 Bolts = 3.5 Nm.

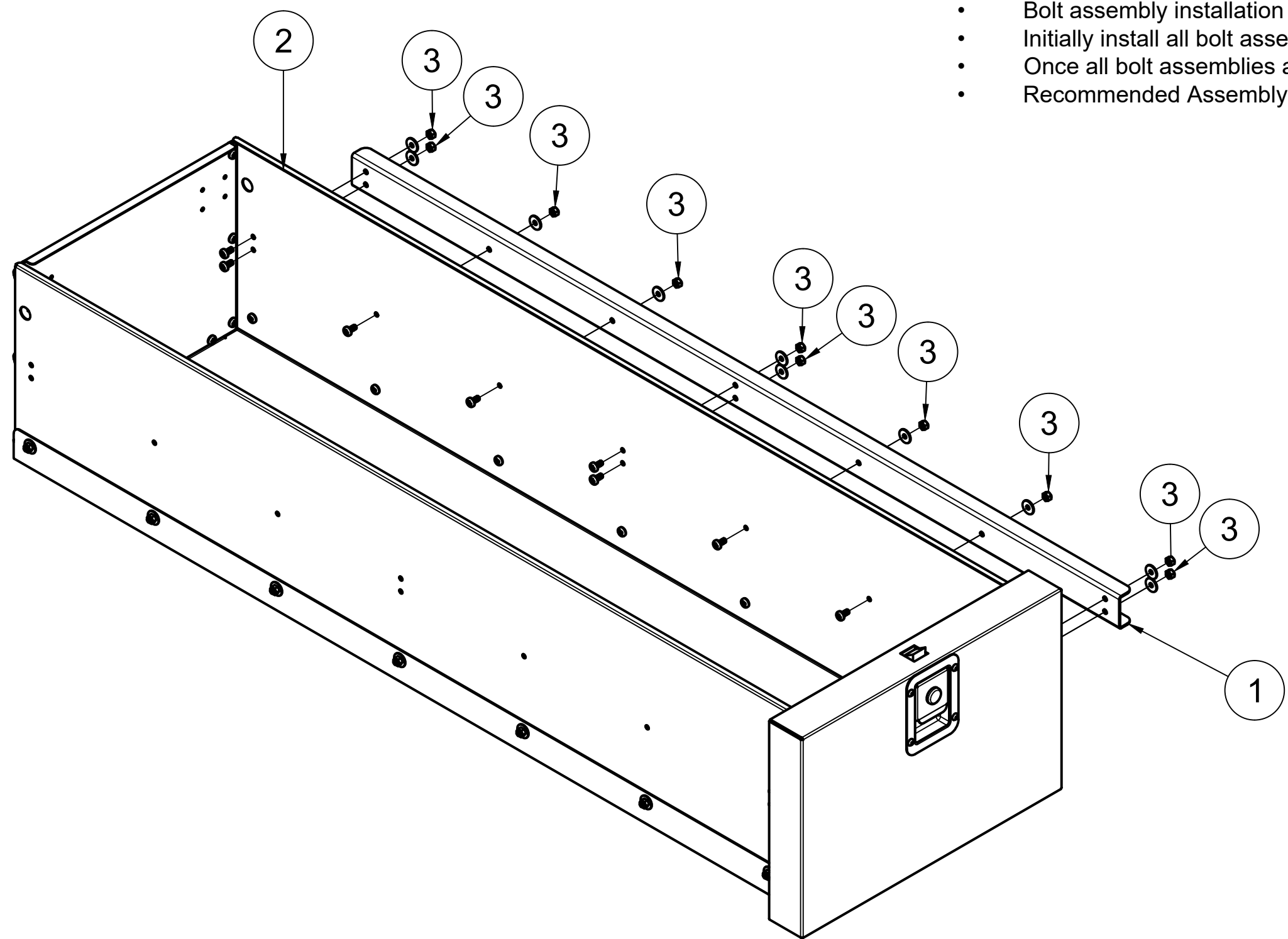

massystems.com.au  
enquiries@massystems.com.au

3	10	M6 Pan Head Bolt Assy
2	1	Drawer Side
1	1	Drawer Rail
Item	Qty	Description
Parts List		

# Step 5.2: Drawer Rail Installation (LH)

DIA - 7.0

- Bolt assembly installation order is not critical.
- Initially install all bolt assemblies hand tight.
- Once all bolt assemblies are in place, fully tighten.
- Recommended Assembly Torque for M6 Bolts = 3.5 Nm.

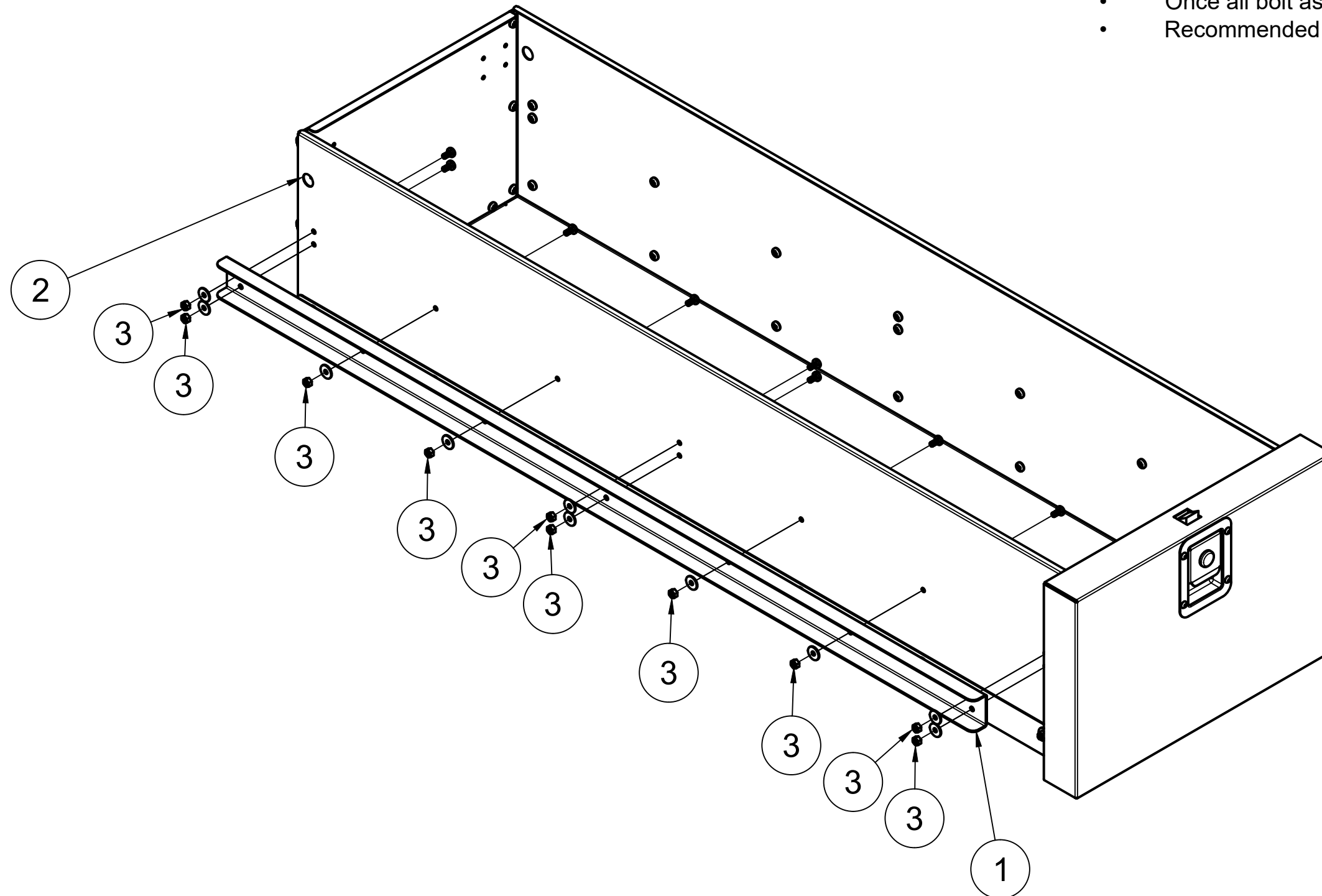

3	10	M6 Pan Head Bolt Assy
2	1	Drawer Side
1	1	Drawer Rail
Item	Qty	Description
Parts List		

# Step 6: Spring Bolt Assembly

DIA - 8.0

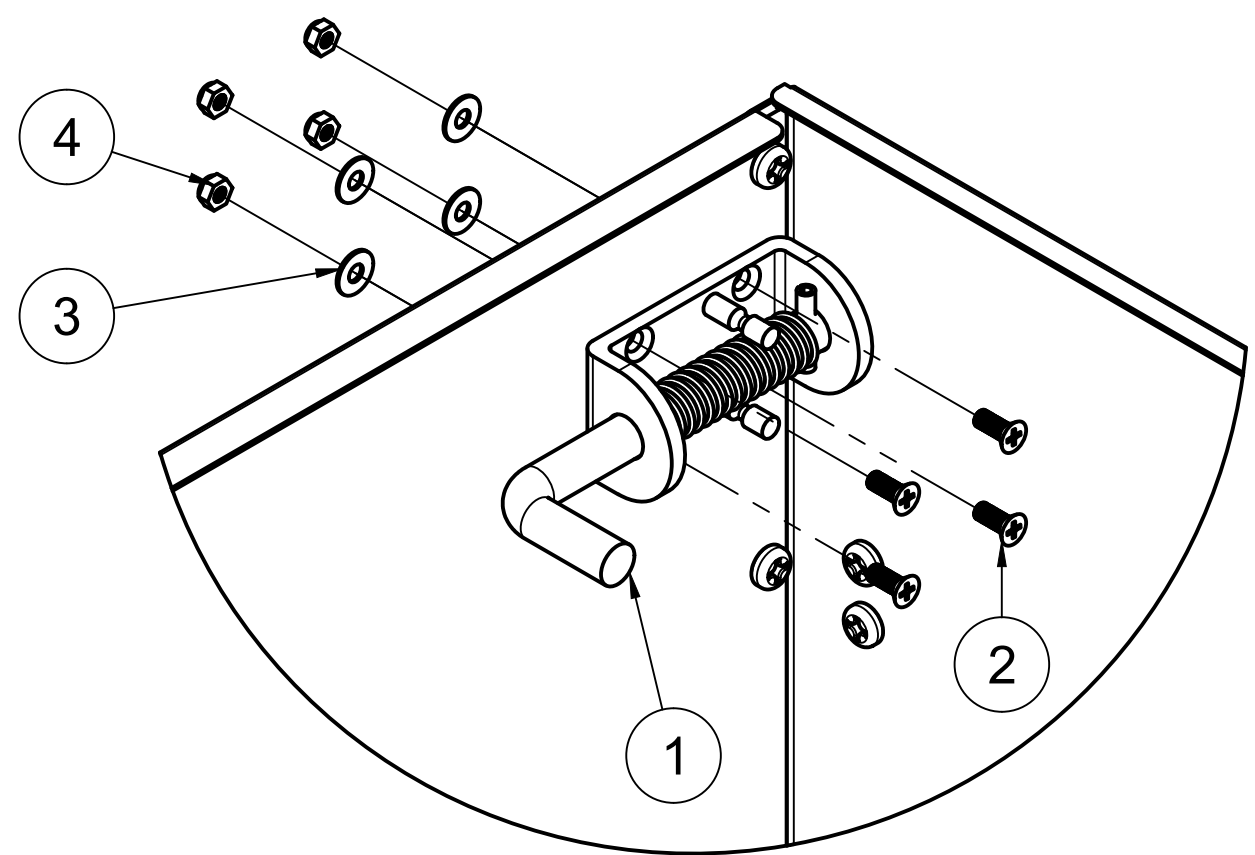
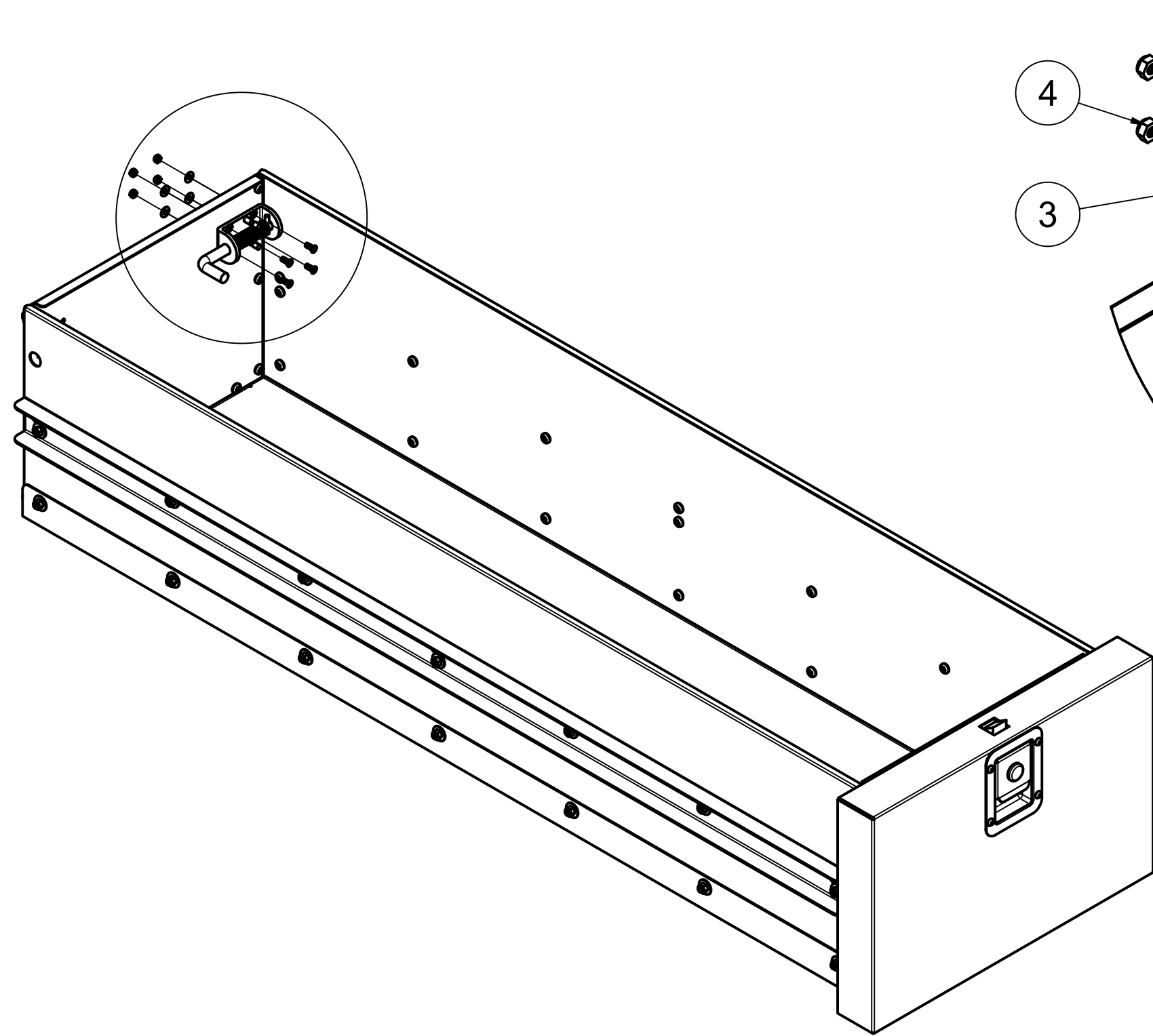

- Bolt assembly installation order is not critical.
- Initially install all bolt assemblies hand tight.
- Once all bolt assemblies are in place, fully tighten.
- Recommended Assembly Torque for M6 Bolts = 2.1 Nm.

4	4	M5 Nyloc Nut
3	4	M5 x 13 Flat Washer
2	4	M5 Counter Sink Screw
1	1	Spring Bolt
Item	Qty	Description
Parts List		

# Step 7: Drawer Front Reveal Panel

DIA - 9.0

Please Note: Drawer Front Reveal Panel is installed during installation stage

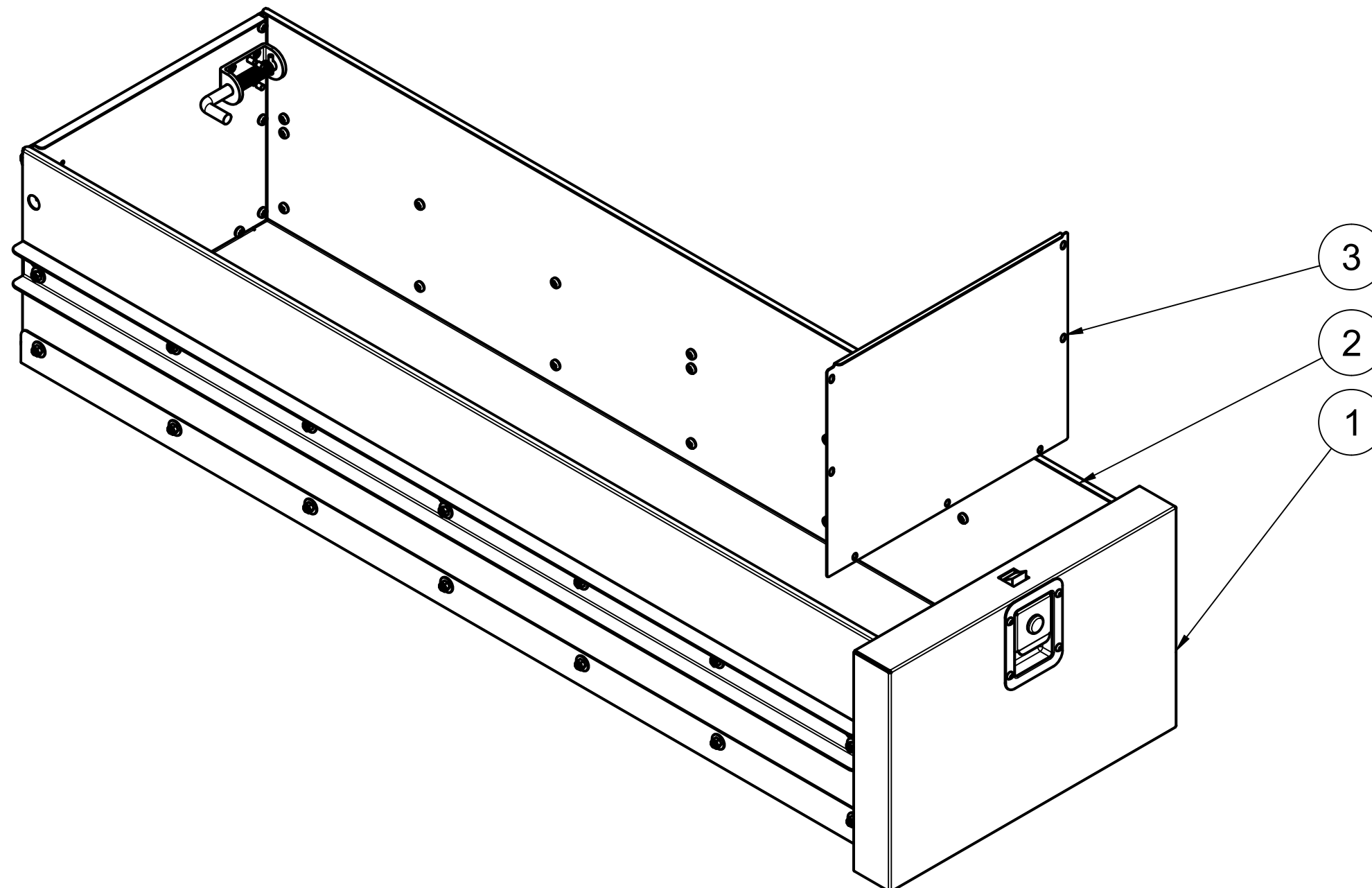

3	1	Drawer reveal Panel
2	1	Drawer Side
1	1	Drawer Front
Item	Qty	Description
Parts List		